

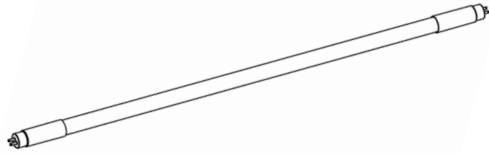

## INSTALLATION GUIDE

### LED Linear T5 Direct(TypeB)



ENSURE POWER SUPPLY IS OFF WHEN HANDLING ANY ELECTRICAL EQUIPMENT.

#### Note:

- Risk of fire or electric shock, Please read and understand the detailed installation instructions before installing the LED T5 tube light.
- If the tube is installed as Type B, the luminaire, once modified as a retrofit fixture will no longer operate fluorescent lamps.
- Do not use where directly exposed to water or weather. Non-submergible (not water tight).
- Use in dry or damp locations only.
- Not suitable for use with dimmer.
- Disable all power to the fixture before inspection, installation, or removal. Failure to do so will create a hazardous and fatal working environment.
- Do not open – No user serviceable parts inside.

#### TYPE B - Assembly Introduction:

Note: The tube can work with double-end and single-end power input

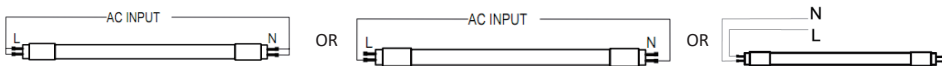

#### Type B Installation Guide:

##### 1. DISCONNECT POWER TO LUMINAIRE

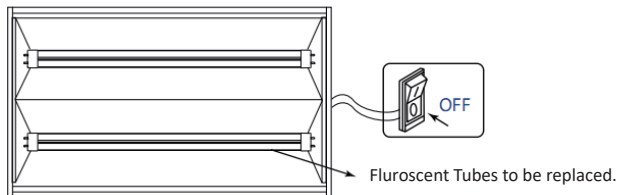

Disconnect power to luminaire or circuit(if possible). Ensure all power is OFF by using a voltmeter or other approved method to confirm.

approved method to confirm.

##### 2. REMOVE EXISTING TUBE LAMP(S)

- Remove troffer lens, if present.
- Remove existing fluorescent tube by rotating one-quarter turn and sliding lamp(s)
- Remove ballast cover.(Cover may be secured with screws or tabs).

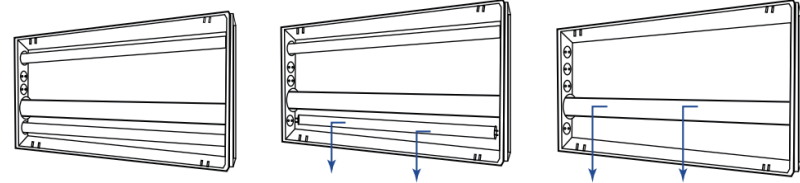

##### 3. a. RETROFIT LUMINAIRE

Disconnect the wires between ballast according to the figure below.

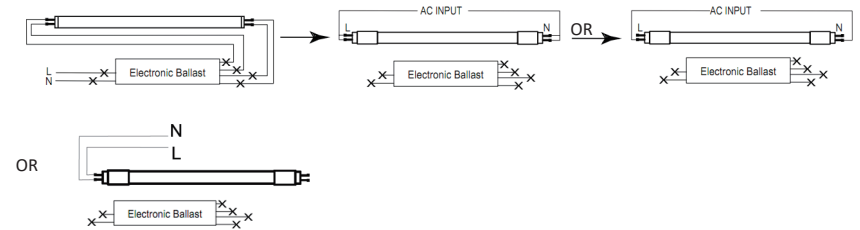

##### 4. INSERT LED TUBES

- Ensure both the ends of the LED tube are aligned with socket, then insert LED lamp in the normal way by sliding pins into sockets and rotating a quarter turn until the LED tube locks in place.
- LED lamps are now fully installed.
- Replace troffer lens, if present.
- After modification completed. Attach the replacement marking and cautionary label to a visible place on the luminaire and keep it visible after installation.

##### 5. RESTORE THE POWER OF LUMINAIRE

Restore power to circuit/luminaire and test light. If necessary, adjust position of LED tube, and enjoy your new LED tube!